

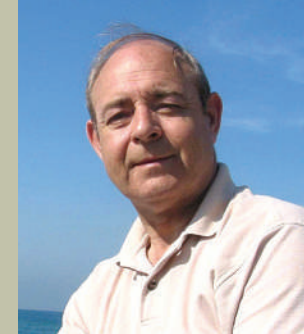

Maxoptra Helps The Tomato Stall Deliver Fresh Produce Across UK

Maxoptra is helping **The Tomato Stall** deliver fresh tomatoes across the country, supplying farmers' markets, farm shops, restaurants and deli's across England. Located on the **Isle of Wight**, The Tomato Stall is a fast growing company with an enviable reputation for its slow grown, full flavoured fruit, and needs to ensure deliveries arrive on schedule and market-fresh to retain that high quality and taste. By using Maxoptra, this south coast grower can now plan efficient routes and get an understanding of the actual cost of individual deliveries. The recently implemented cloud based solution is already saving time and money, and it is hoped its ongoing use will further support The Tomato Stall's environmental ethos. www.maxoptra.com



Peter Fitzgibbon,
Editor

What's where and why?

You might well ask, particularly when shifts in county boundaries lead to confusion over what is where. Is Wigan in Greater Manchester or Lancashire? Or is Grange-over-Sands in Cumbria or Lancashire? Just two of more than 600 English towns and villages that have no clear county affiliation according to the British Counties Campaign, a Facebook group that seeks to end the confusion by restoring the nation's 92 ancient counties.¹

For Danny Dorling, Professor of Geography at the University of Oxford, resurrecting the past in this way could create even more confusion. Yet, as a social geographer, he questions why our county boundaries are subject to so much change. Tackling the issue on BBC Radio², he pointed to the gradual disempowerment of local government as a principal reason for centrally-imposed changes that have led to "some of the most confusing boundaries in the world."

Just look at the proliferation of counties, each with slightly varying boundaries: ceremonial counties, ancient counties, shrieval counties, administrative counties, postal counties, census counties, metropolitan and non-metropolitan counties, and so on. That said, Dorling believes we have no option other than to "live with the confusion we've created for ourselves, I'm afraid it's just part of being British that we have created the most complicated geography in the world."

Just to keep the pot boiling, and as we go to press, the presumed villain of the piece – the Boundary Commission for England – is about to publish revised proposals for boundaries that will re-draw the map of Parliamentary constituencies³ And with more than 25,000 comments from members of the public on the initial proposals, it could be a tough call. That much is admitted by Tony Bellinger, Deputy Secretary to the Commission, who blogs, "In many areas, more than one alternative approach has been proposed, so it can become a pretty tough job to find a solution that works for everyone, though we do try!"

¹ <https://www.facebook.com/BritishCounties/>
² BBC Radio 4 Today Programme, 13 Sep 2017
³ <https://boundarycommissionforengland.independent.gov.uk/coming-soon-revised-proposals/>

McCarthy & Stone select Cadcorp software for more efficient Workforce Planning

As **McCarthy & Stone** enjoys rapid growth, for their HR department, providing continuity of cover and improving efficiencies was both time consuming and increasingly complex. The HR department selected **Cadcorp** desktop product **Map Modeller** and use it as their territory management software. **Tania Harland, HR Advisor at McCarthy & Stone** remarked, "The **Cadcorp GIS** has been a huge time saver for me. It has taken what was originally a heavily manual based process to a quicker, smarter way of carrying out Workforce Planning." Automating Workforce Planning has freed up more time for the HR department to meet their business objectives. www.mccarthyandstonegroup.co.uk www.cadcorp.com

Bryden Wood Partners 3D Repo

3D Repo is partnering with **Bryden Wood** to develop 4D sequence visualisation features for their database driven **Digital Construction Platform**. These features will allow users to visualise 3D construction projects, over time, directly from their existing BIM models. Outputs will be viewable not only in 3D Repo's web based platform, but also by loading directly from the cloud and viewing via market leading virtual reality headsets such as Oculus and HTC Vive. 4D modelling is a term used in the construction sector and refers to the fourth dimension of time, so 4D schedule is a 3D model that includes the construction sequencing. This enables teams to analyse events on a time-line and visualise the duration it takes to complete tasks within the construction process. www.3drepo.org



Bluesky National Tree Map Helps Dudley Council Protect Urban Trees



Dudley Metropolitan Borough Council is utilising Bluesky's National Tree Map (NTM) data to help ascertain numbers for a borough wide inventory of trees. The Arboricultural Section of Dudley Council has the management responsibility for trees on different departments, in addition, Dudley Council has a published Tree Strategy, which promises to enhance and protect the authority's tree stock. The Bluesky NTM data, which identifies the location, height and canopy cover of more than 280 million trees across Britain, is being used within Dudley Council's corporate GIS. Combined with existing data layers, such as Ordnance Survey mapping, the Local Land and Property Gazetteer, Dudley's Land Terrier and recent aerial photography, it allows officers to quickly identify trees that fall within areas owned or managed by the Council. www.bluesky-world.com

Record start to 2017 for investment into London and UK tech companies

Record levels of venture capital investment at the start of 2017 has helped London retain its crown as Europe's number one tech hub for global investors, according to new data from London & Partners, the Mayor of London's promotional agency. Despite the UK's decision to leave the European Union, VCs have pumped more than £1.1 billion into London's tech sector over the last six months with the total invested across the UK as a whole topping £1.3 billion between January and June. The start of 2017 has seen over four times the amount of investment than at the same stage during 2013 and more than any other six month time period in the last decade. www.londonandpartners.com

River Thames simulation supports safer navigation for Tideway

HR Wallingford is assessing Tideway's fleet of vessel masters at its UK Ship Simulation Centre to ensure they meet Tideway's health and safety. The £4.2 billion Thames Tideway Tunnel project is required to bring London's sewers into the 21st century, and to stop tens of millions of tonnes of untreated sewage flowing into the Thames each year. The 'super sewer' is a tunnel running under the Thames that will intercept, store and transfer the sewage overflow for treatment. The tunnel starts in West London and follows the route of the River Thames to Limehouse, before heading north-east to Abbey Mills Pumping Station near Stratford. At Abbey Mills the Thames Tideway Tunnel will connect to the Lee Tunnel, which will transfer the intercepted sewage for treatment at Beckton, East London. www.hrwallingford.com



Arithmetica Announces New License Options Ahead of Pointfuse V3 Launch

Arithmetica has announced a new monthly licensing option for Pointfuse V3 which will be released later this month. Suited towards project-specific usage, Pointfuse now offers a monthly licensing option. Pointfuse V3 is available for

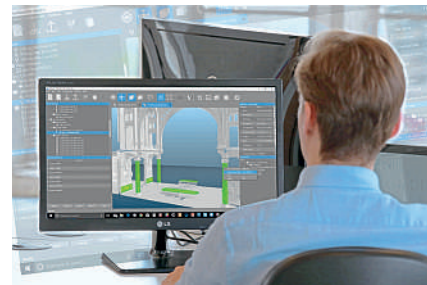

download now. Pointfuse is a powerful modeling engine that delivers an automatic, precise and flexible way of converting the vast point cloud datasets generated by laser scanners or photogrammetry into segmented mesh models. Designed for anyone capturing or using point cloud data, Pointfuse uses advanced statistical techniques to create 3D models where individual surfaces can be selected and classified as new layers in the Pointfuse environment and exported to IFC and FBX for manipulation in any industry-standard CAD system. www.arithmetica.com

EarthSense Real Time Air Quality Monitoring for Low Emission Lorry Trial

EarthSense Systems is equipping commercial delivery vehicles with air pollution sensors as part of a project to test the performance and emissions of low-carbon lorries. The research is part of the Temperature-controlled Range-extenders and Integrated Urban Mapping of Pollution (TRIUMPH) project, led by logistics provider Kuehne + Nagel and supported by Cenex – the UK's first Centre of Excellence for low-carbon technologies. The TRIUMPH project will see Kuehne + Nagel introduce four fully electric lorries: two range extended electric vehicles and two liquid nitrogen cooled refrigeration vehicles. These vehicles will be used to make food deliveries to Whitbread hospitality brands, such as Costa and Premier Inn. This is the first trial of its kind to make the business case for investment in zero emission capable trucks and zero emission temperature controlled transport. www.earthsense.co.uk



Over 75% of space already booked for UK's largest geospatial event

GEO Business – the UK's largest geospatial exhibition and conference, is well on track for another successful edition next year, when it returns to the Business Design Centre, in London, on 22-23 May 2018. Since its record-breaking 2017 event, which welcomed 2,386 geomatics and geospatial professionals from around the world, stands have been selling at an unprecedented rate. Organisers, Diversified Communications UK, are urging new suppliers looking to reach this important market to book early to ensure their place. The aisles were packed with senior managers and decision makers working in architecture, construction, engineering, housing associations, councils, and many more. Exactly the people, exhibitors want to do business with. The high demand for the 2018 show certainly reflects this. www.divcom.com

eBee⁺

Aerial **efficiency**,
photogrammetric **accuracy**



Large coverage for optimal efficiency

The eBee Plus can map more square kilometres per flight, than any drone in its weight class, allowing you to maximise your efficiency and plan projects with confidence.

High Precision on Demand (HPoD)

The eBee Plus includes built-in RTK/PPK functionality that can be activated either out of the box or later when required. It's survey-grade accuracy you control, without the need for ground control points—for less time in the field and more time putting your data to work.

Project-perfect payloads

The eBee Plus offers a camera to suit every application, including the senseFly S.O.D.A. (supplied), the first camera designed for photogrammetric drone mapping.