



Peter
Fitzgibbon,
Editor

Forging a new partnership

Amid the uncertainties surrounding Brexit, it is perhaps timely to look at one of the less publicised negotiating objectives set out in the Government's White Paper earlier this year.¹ Among the 12 priorities that the UK government will use to negotiate Brexit is that of ensuring the UK remains the best place for science and innovation. 'We will remain at the vanguard of science and innovation and will seek continued close collaboration with our European partners,' is the stated objective here.

The White Paper notes the UK's contribution to cutting-edge research and innovation within the EU: active participation in the Horizon 2020 science programme; a major role in the Galileo satellite navigation and Copernicus satellite remote sensing initiatives, and its commitment to €1.4 billion of funding to the European Space Agency over the next four years. 'As we exit the EU, we would welcome agreement to continue to collaborate with our European partners on major science, research and technology initiatives,' it states.

Others, too, are getting their act together to support the Government as negotiations get underway. For example, the Royal Academy of Engineering is co-operating with 37 organisations representing the engineering profession to ensure that the needs of all sectors that have a dependence on engineering are represented and understood. Similarly, the RICS, RIBA, CIOB and RTPI have joined to outline their concerns on six priorities in construction and the built environment on which the Government should focus in its negotiations.²

So isn't it time for a single voice to represent the geotech sector? Wouldn't it make sense for the AGI, RGS, SoC, BCS, BARSC, RSPSoc and others to put their heads together to ensure the Government is fully supported in maintaining the UK's strong presence in Europe?

1. *The United Kingdom's exit from and new partnership with the European Union*. Cm 9417, February 2017

2. <http://www.rics.org/uk/footer/brexit/>



Maxoptra is the purrrrrfect partner for expanding Natures Menu

Maxoptra dynamic scheduling and vehicle routing software has proved 'business critical' for raw pet food manufacturer **Natures Menu**. Sales of natural pet food grew by nearly 30 percent last year and Natures Menu has seen a fourfold increase in the size of its delivery fleet since they introduced Maxoptra software. The company now makes around 150,000 temperature controlled deliveries per annum, and will open a brand new manufacturing plant this year to deal with increasing consumer demand and to deliver new innovation to the market. Each day orders are automatically exported from the company's Enterprise software into Maxoptra, where intelligent route planning and optimisation features are used to auto-plan around 600 deliveries to retailers and consumers' home addresses. www.maxoptra.com

Cadcorp offering Workload Modelling Analysis Service

In addition to providing GIS software, support and consultancy for **UK fire services** to perform their own analysis, **Cadcorp** will now independently perform modelling on their behalf. A significant number of UK fire services are using **Cadcorp Map Modeller** and **Workload Modeller** to assist in the production of their **Integrated Risk Management Plans**. Map Modeller is used to map resources and demand, and perform spatial analysis. Examples may include thematic maps, hotspot maps and travel time analysis. Workload Modeller builds upon this by allowing fire services to make changes to the resources available and model the impact of those changes on operational performance. While fire services can perform this analysis themselves, a number of Fire Services are choosing an independent consultancy service. www.cadcorp.com

Allstar and Masternaut join forces to make fuel cards smarter

Masternaut and **Allstar Business Solutions** have partnered to launch a smarter fuel card solution. **Masternaut's Fuel & Maintenance Card** links straight into its telematics platform, providing alerts on misuse and automatic reports to save time and money. By combining a strong software platform, location data, and fuel cards, the Fuel & Maintenance Card gives HR, Fleet Managers, and Operations Managers the tools to save time and money in a smarter way by stopping misuse without tedious, manual checks and saving money on fuel and maintenance with the biggest networks in the UK. Fuel, an already costly element of running a business, can be an area open to error or fraud. www.masternaut.com



Risk Insight improves precision underwriting for RSA and its brokers

Europa Technologies has customised its precision risk assessment platform, Risk Insight, to create a broker-friendly tool for RSA called **GeoRisk Broker**. This tool will deliver improved risk scoring and lead to more accurate underwriting for broker driven business. RSA had already selected Europa Technologies to provide Ordnance Survey data and a number of complementary hosted services. GeoRisk Broker is now being rolled out to RSA's brokers and has had a very positive reception. It is expected that the application will evolve to meet the growing needs of the organisation. **Finlay Smith, RSA's UK & International Chief Underwriting Officer**, commented, "GeoRisk Broker will ultimately help to improve the profitability of our business." www.europa.uk.com

Northumbrian Water saves £8.75m with 1Spatial Digital Asset Management & Mapping

An industry-leading partnership between **Northumbrian Water** and **1Spatial**, will help to enhance response times for customers who experience problems with the sewer network in and around their properties. Key benefits are: £8.75 million saved on survey costs for transferred networks, Mapping completed in 1/8 of the time originally planned, Better data ensures better customer service and asset investment plans. 1Spatial proposed an approach built on its **1Integrate** solution. Working with subject-matter experts at Northumbrian Water, the team developed a series of rules to infer the missing information, based on limited records available and the expertise of staff. Choosing 1Spatial's rules-based approach dramatically reduced both the time and cost of the project. www.1spatial.com

3D Repo Joins Open Building Information Modelling Revolution

3D Repo has signed up to the **Open BIM Programme** that is designed to provide a universal approach to the collaborative design, realisation and operation of buildings based on open standards and workflows. **Open BIM** is an initiative of leading software vendors using the **buildingSMART Data Model** based on open standards such as Industry Foundation Classes (IFC) and BIM Collaboration Format (BCF). Through the use of its award winning open source software solutions, and its support of the Open BIM programme, 3D Repo joins other members of the growing Architecture, Engineering and Construction (AEC) community in promoting successful and streamlined collaboration on BIM projects anywhere in the world. www.3drepo.org

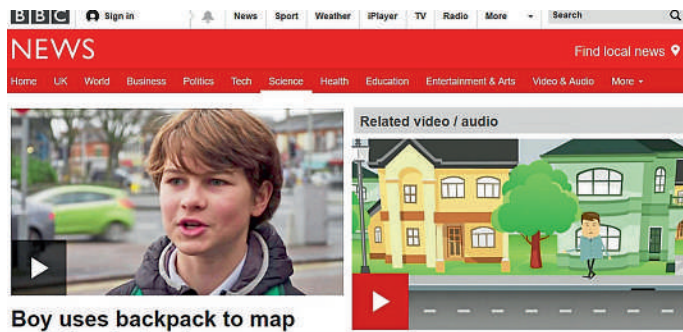
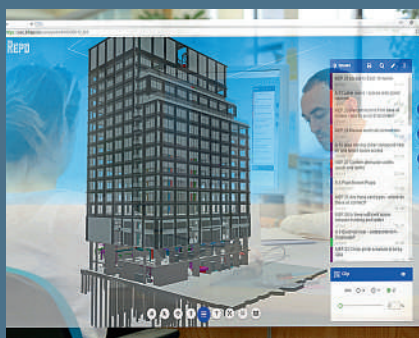

Boy uses backpack to map pollution hotspots

5 March 2017 Last updated at 17:53 GMT

Scientists at the **University of Leicester** are trialling a portable air monitor to gather precise data at a personal scale.

Schoolboy Logan Eddy has been helping the study by carrying the device in a specially adapted backpack.

What does air pollution do to our bodies?



EarthSense Scientists Help Pupils Map Air Pollution for BBC News

Scientists from **EarthSense Systems** were featured in a week-long schedule of reports on air pollution shown on the **BBC One News at Six**. In the first in the series, **David Shukman** explores the potential issue of air pollution and school children. He explained how students at a secondary school in North West Leicestershire used a new air quality sensor to measure pollution levels along a busy street in Leicester. The geographically referenced information was then automatically transmitted to the EarthSense laboratory for analysis. The equipment used in the project was the **Zephyr** sensor developed by EarthSense Systems, which accurately measures pollutants Nitrogen Dioxide and Ozone. www.earthsense.co.uk

HR Wallingford celebrates 70 years making waves



HR Wallingford is celebrating 70 years of working with water. Founded in March 1947 in Teddington, as the Hydraulics Research Organisation, the company moved to Wallingford in 1951, to take advantage of Howbery Park's 70 acre site and riverside location. Its large-scale tests and experiments needed lots of space and a plentiful supply of water, all of which Howbery Park could offer, including a historic Manor House which could be adapted for office use. **Dr Bruce Tomlinson, HR Wallingford's Chief Executive**, says: "Our water-related research and consultancy is as relevant today as it was 70 years ago. Since then, Howbery Park has also grown, developing into a successful business park with a strong commitment to sustainability." www.hrwallingford.com

GGP Celebrates 25 Years

In February 2017, **GGP Systems Ltd.**, celebrated twenty five years at the forefront of the development of modern **Geographic Information Systems**. GGP has launched many state of the art GIS and Address Management solutions for the public sector during their 25 year journey and has continued to pioneer the development of corporate GIS for Local Authorities in the UK, as well as innovative developments in the areas of gazetteer management systems, web-delivered mapping technology and highly interoperable solutions for shared services. **Managing Director and founder Tim Maxwell** said, "We are proud of our achievements over the past 25 years and we look forward to continuing our commitment to GIS and Address Management solutions throughout the UK over the next 25 years." www.ggpsystems.co.uk